

Bo Ming Scaffolding (H.K.) Limited 寶銘棚架(香港)有限公司



3488 3860



3488 3861



bmskh.sales@gmail.com



www.bmskh.hk



1450 Mobile Aluminium Scaffold Tower

Tested and Certified to EN 1004-1:2020 (Class 3)

Tower Dimension : 1.45m(W) x 1.8m(L) x 10.85m(H)
 Max. Platform Height : 9.7m, Max. Working Height : 11.7m

Maximum Working Load :
 Tower - 950 kg including tower self weight
 Platform - 275 kg when load uniformly distributed

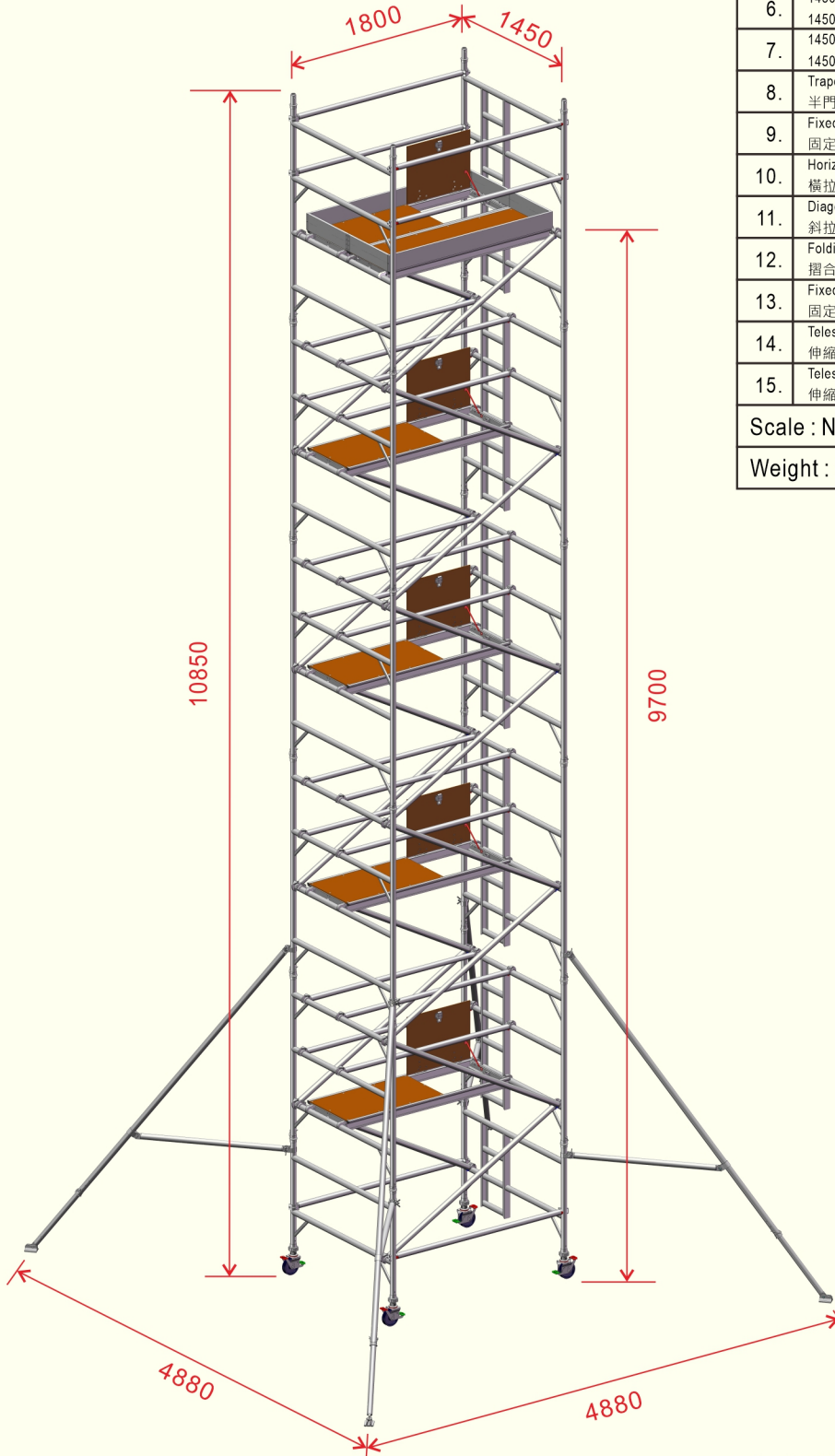

Item 項目	Description 配件名稱	Qty. 數量
1.	Castor Wheel 150mm dia. W/Adj. Leg 150mm 腳輪連調節槽	4
2.	1450 2 Rung Ladder Frame 1.45 x 1.0m 1450 2 橫閘梯架 1.45 x 1.0m	1
3.	1450 2 Rung Span Frame 1.45 x 1.0m 1450 2 橫閘架 1.45m x 1.0m	1
4.	1450 3 Rung Ladder Frame 1.45 x 1.5m 1450 3 橫閘梯架 1.45 x 1.5m	1
5.	1450 3 Rung Span Frame 1.45 x 1.5m 1450 3 橫閘架 1.45 x 1.5m	1
6.	1450 4 Rung Ladder Frame 1.45 x 2.0m 1450 4 橫閘梯架 1.45 x 2.0m	4
7.	1450 4 Rung Span Frame 1.45 x 2.0m 1450 4 橫閘架 1.45 x 2.0m	4
8.	Trapdoor Platform 600 x 1800 半門踏板 600 x 1800	5
9.	Fixed Platform 600 x 1800 固定踏板 600 x 1800	1
10.	Horizontal Brace 1800 (Red) 橫拉杆 1.8m (紅色)	22
11.	Diagonal Brace 2100 (Blue) 斜拉杆 2.1m (藍色)	18
12.	Folding Toeboard 1200 x 1800 摺合踢腳板 1.2 x 1.8m	1
13.	Fixed Outrigger - Small 固定斜撐 (小型)	-
14.	Telescopic Outrigger - Medium 伸縮斜撐 (中型)	4
15.	Telescopic Outrigger - Large 伸縮斜撐 (大型)	-

Scale : NTS Ref. : DW-10700-18

Weight : approx. 304.0 kg